

TR-Electronic Miniature Multi Turn Rotary Encoder Product Information CMV 22 M

22 mm

















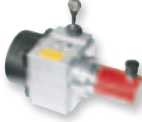



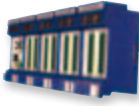

TR-Electronic – Your Partner in Automation

TR-Electronic can look back on more than 25 years of success, and is represented worldwide with an export share of more than 40 %. The core business comprises the development and manufacture of industrial angular and position measuring technology, as well as compact drive technology with integrated position control and measurement. The company is divided into three Business Units (BU) and is thus well positioned for further growth in the future.

Products in the **Rotary Encoder Business Unit** with optical or magnetic scanning precisely acquire position in steel production, wind power plants, cranes and ships as well as in explosion-proof versions in painting lines. Miniature versions ensure the correct position in medical technology. SIL3 approved absolute rotary encoders ensure the necessary safety.

In the **Linear Encoders Business Unit** magnetostrictive position sensors position injection molding machines, for example, or are directly integrated into hydraulic cylinders. Cascadable distance measurement sensors position parting units. With their high precision, glass scales on machine tools ensure precise position. Laser sensors based on phase difference measuring techniques position aisle stackers in warehousing and materials handling technology.

In the **Drives Business Unit** angle sensors are combined with compact drives: no external electronics are required, position, speed and torque controllers, power electronics and absolute rotary encoders are compactly integrated into the drive and thus bring intelligence directly to the drive shaft via the field bus. Compact drives are used for diverse applications in the printing and packaging industry and on palletizers.

					
					
Rotary Encoder	Linear Encoder	Drives	Components	Engineering	Unidor
 Incremental Encoder  Absolute Encoder  Draw Wire Encoder	 Magnetostriction  Glass scale  TOF laser  Barcode Positioning	 Actuator  Positioning Drive  Processing Drive	 I/O Module  Controls  Industrial-PC	Automation Solutions  Retrofit 	Punching and forming Measurement and control systems  Sensors  Process monitoring tools 

The portfolio is supplemented by the affiliated **TRsystems** with customized controls, industrial PCs, hydraulic controls as well as control units and sensors for punching and forming.

An essential factor for the success of **TR-Electronic** are the now more than **300 employees** who actively help to shape the product portfolio with innovations and successfully implement customer projects. Through its commitment to the regional colleges, TR-Electronic supports the high quality training of young employees and thus guarantees the highest level of innovation and quality at its Trossingen location.

A high degree of vertical integration allows customer-specific requirements to be responded to very quickly. The constantly new requirements on the mechanical design of sensors, on innovative new operating interfaces and new plug connectors result in a rapidly increasing product diversity. With **TR-Electronic** you have a partner who can fulfil these requirements.

Content

General

Absolute miniature rotary encoder – Application and technology	3
Product overview – TR-Electronic – Your partner for automation	8
Addresses – Distribution Germany and International	10

Miniature rotary encoder CMV 22 M

With analog interface – CMV 22 M analog	4
With SSI – CMV 22 M SSI	6

Absolute Miniature Rotary Encoder

Within the CMV 22 M we have combined our innovative ideas of rotary encoder technology and the experience gained over the years and placed it into a miniature rotary encoder. With a 22 mm diameter, it is the smallest absolute multi turn rotary encoder of its kind. Amazingly compact, it can be easily mounted in the most confined machine spaces. The contact-free detection guarantees shock and vibration resistance which combined with its low mass make it perfect

for use in demanding environments.

Within many axis positioning systems there are often control parameters located very close to the main position, multi-ganged potentiometers are vulnerable to early failures at those positions; whereas the contact-free CMV 22 M does not share this weakness and can provide short-sharp motion control signals reliably throughout the systems life time.

Direct installation into servo drives for wear-free, absolute position detection over several revolutions.

The small size of 22 mm enables a real multi-turn position measuring without battery back-up at places like apparatus construction and medical engineering, where up till now only incremental rotary encoders or multiple-ganged potentiometers were used.

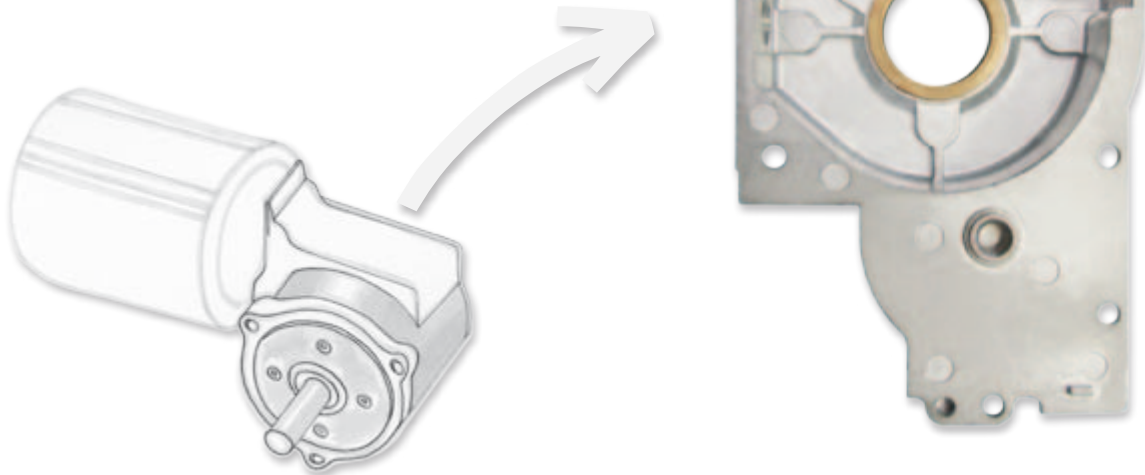

Technology

The use of a CMV 22 M ensures a real multi turn position measuring without the need of a mechanical stop reference position.

The axial position is sampled over several revolutions using contact-free magnetic sensors. Immediately when switched on, the absolute position value is available without the need of an internal back-up battery or an external counter.

Due to its compact size, the CMV 22 M is only available with pre-cabled connectivity.



Miniature Rotary Encoder CMV22 M With Analog Interface

- + analog interface
- + power and voltage
- + endless potentiometers
- + contact-free measurement procedure
- + roller bearing for a long operating life at a high speed
- + special parameters on request
- + alternative shaft / flange combination possible



Supply

Power supply	14 ... 30 V DC
Power input without demand	< 50 mA

Measured value acquisition

Capacitance ¹⁾	≤ 20 bit
Steps / revolution ¹⁾	≤ 4.096
Revolution ¹⁾	≤ 256
Accuracy	±1 °

Interface

Voltage	0 ... 10 V
- Load resistance	≥ 20 kΩ
- Maximum cable length	10 m (electrical shielding)
Current	0 ... 20 mA
- Load resistance	< 500 Ω
Resolution	15 bit
Cycle time	500 μs
Parallel input bit	Counting direction, Preset
Input bit level	„0“ < +2 V DC, „1“ = Supply voltage

Mechanical features

Mechanically permissible speed	≤ 3.000 min ⁻¹
Shaft load (shaft end)	≤ 10 N axial, ≤ 5 N radial
Bearing life time	≥ 30 × 10 ⁹ revolution at ≤ 3.000 min ⁻¹ ≤ 25°C Shaft load ≤ 5 N axial, ≤ 0 N radial
Mass (typ., without cable)	60 g

Environmental conditions

Vibration DIN EN 60068-2-6	≤ 100 m/s ² , sine 50–2.000 Hz
Shock DIN EN 60068-2-27	≤ 1.000 m/s ² , half-sine, 11 ms
EMV	Transient emissions DIN EN 61000-6-3 Immunity to disturbance DIN EN 61000-6-2
Working temperature	0 °C ... +60 °C
Storage temperature	0 °C ... +85 °C, dry
Relative humidity, DIN EN 60068-3-4	95 %, no condensation
Protection class DIN EN 60529 ²⁾	IP 64

¹⁾programmable parameter

²⁾valid with screwed on mating connector and / or screwed together cable gland

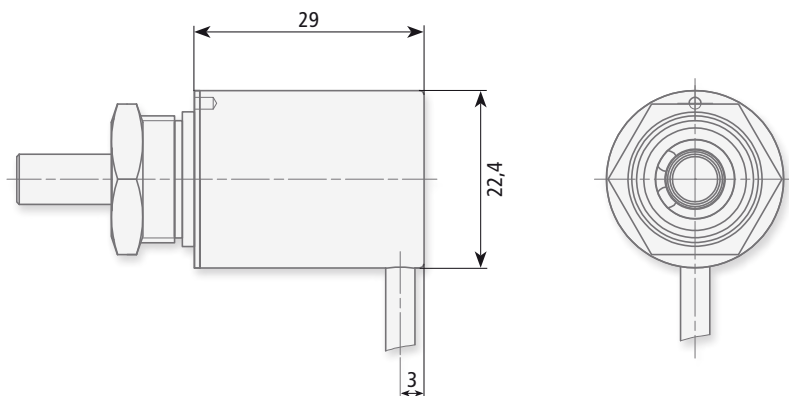

Please ask your project manager for detailed drawings.

Our recommendation

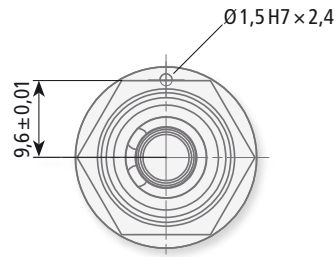
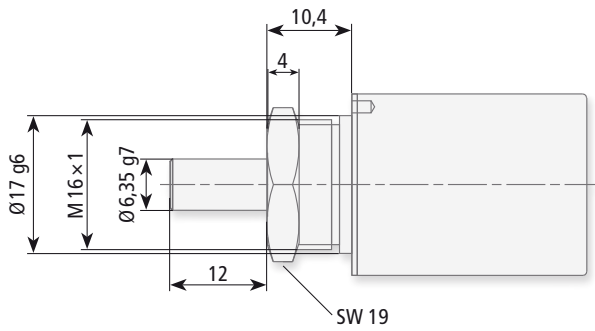

Order information analog voltage 0 ... 10 V

Order number	CMV 22 M-00008
<ul style="list-style-type: none"> + Shaft: 6,35 mm (1/4"), glatt x 12 mm + Cable gland: radial + 0,5 m cable with open end, not finished + measurement range programmable + input for switching counting direction 	

Order information analog current 0 ... 20 mA

Order number	CMV 22 M-00024
<ul style="list-style-type: none"> + Shaft: 6,35 mm (1/4"), glatt x 12 mm + Cable gland: radial + 0,5 m cable with open end, not finished + measurement range programmable + set an input preset value 	

Further options

Mechanic

Shaft 6 mm, flat x 12,7 mm

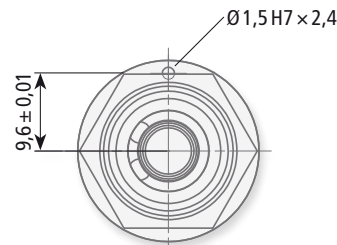
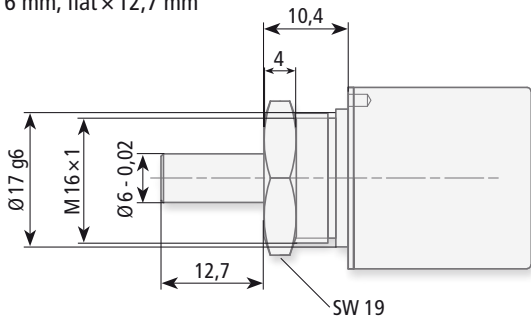

Shaft 3 mm, surface x 4,5

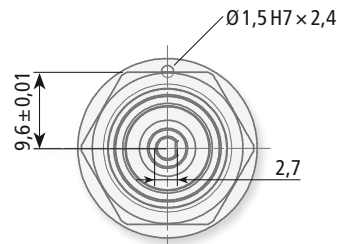
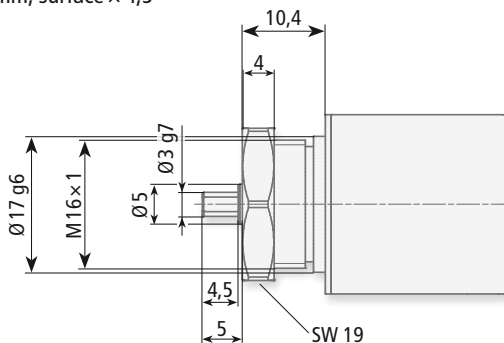

Interface

Cable length	0,3 ... 5 m
Termination	open end, connector
Programming	customer specific pre-programming
Control input	forward/backward, preset

Miniature Rotary Encoder CMV22 M SSI

- + synchronous-serial interface
- + programmable
- + contact-free measurement procedure
- + roller bearing for a long operating life at a high speed
- + special parameters on request
- + alternative shaft / flange combination possible



Supply

Power supply	14 ... 30 V DC
Power input without demand	< 50 mA

Measured value acquisition

Capacitance	≤ 24 bit
Steps / revolution	≤ 4.096
Revolution	≤ 256
Accuracy	±1 °

Interface

SSI	synchronous-serial interface
Clock input	Optocoupler
Data output	RS-422, 2-wire
Clock frequency	80 kHz – 1 MHz
Mono time t_M	$16 \mu s \leq t_M \leq 25 \mu s$, typical 20 μs
Output code ¹	Binary, gray
Output	Position or speed
Cycle time	500 μs
Displaying negative values	Prefix + value, 2's-complement
SSI- or parallel special bits	End switch, over speed, direction signal, motion signal, error signal, parity
Parallel input bit	Counting direction, Preset
Input bit level	„0“ < +2 V DC, „1“ = Supply voltage

¹programmable parameter

²valid with screwed on mating connector and / or screwed together cable gland

Mechanical features

Mechanically permissible speed	≤ 10.000 min ⁻¹
Shaft load (shaft end)	≤ 10 N axial, ≤ 5 N radial
Bearing life time	≥ 30 × 10 ⁹ revolution at ≤ 3.000 min ⁻¹ ≤ 25 °C Shaft load ≤ 5 N axial, ≤ 0 N radial
Mass (typ., without cable)	60 g

Environmental conditions

Vibration DIN EN 60068-2-6	≤ 100 m/s ² , sine 50–2.000 Hz
Shock DIN EN 60068-2-27	≤ 1.000 m/s ² , Half-sine, 11 ms
EMV	Transient emissions DIN EN 61000-6-3 Immunity to disturbance DIN EN 61000-6-2
Working temperature	0 °C ... +60 °C
Storage temperature	0 °C ... +85 °C, dry
Relative humidity, DIN EN 60068-3-4	95 %, no condensation
Protection class DIN EN 60529 ²	IP 64

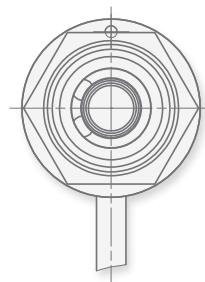
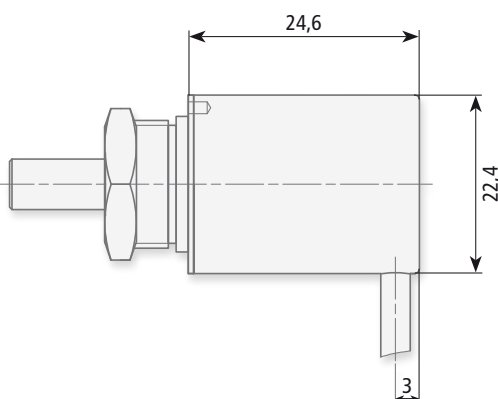

Please ask your project manager for detailed drawings.

Our recommendation

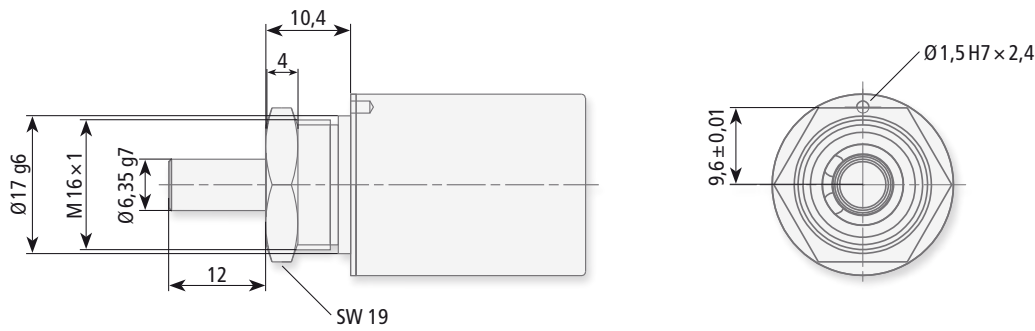

Order information synchronous-serial interface

Order number	CMV 22 M-00010
<ul style="list-style-type: none"> + 24 data bit + shaft: 6,35 mm (1/4"), glatt \times 12 mm + cable gland: radial + 0,5 m cable with open end, not finished + measurement range programmable + input for switching counting direction 	

Further options

Mechanic

Shaft 6 mm, flat \times 12,7 mm

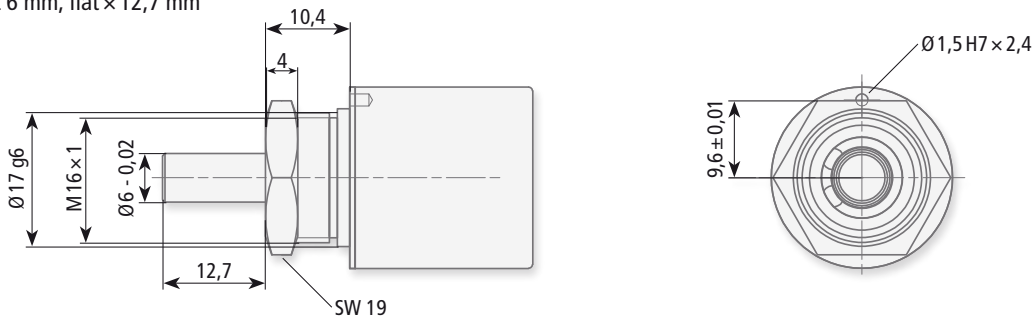

Shaft 3 mm, surface \times 4,5



Interface

Cable length	0,3 ... 5 m
Termination	open end, connector
Programming	customer specific pre-programming
Control input	forward/backward, preset

TR-Electronic – Your Partner in Automation

General/Definition

CMV 22 M

With Analog Interface

With SSI



Programmable rotary encoder

The standard of automation technology, available with all current fieldbus systems: PROFIBUS, Interbus, CANopen, DeviceNet and Industrial Ethernet. Including TR-Electronic's variety of mechanics, interfaces and functions.



Incremental rotary encoder

From 24 mm external diameter up to 55 mm hollow shaft – we always have a solution!



Motor feedback systems

Feedback encoder for modern positioning drives. Optional integrated or directly mounted on the drive shaft via hollow shaft.



Linear absolute displacement sensors

The compact class for linear absolute measurement. Directly bus-ready, suitable for harsh environmental conditions and for installation in hydraulic cylinders.



Absolute high resolution linear measurement systems

Linear measurement with absolute sub-micron resolution without referencing.

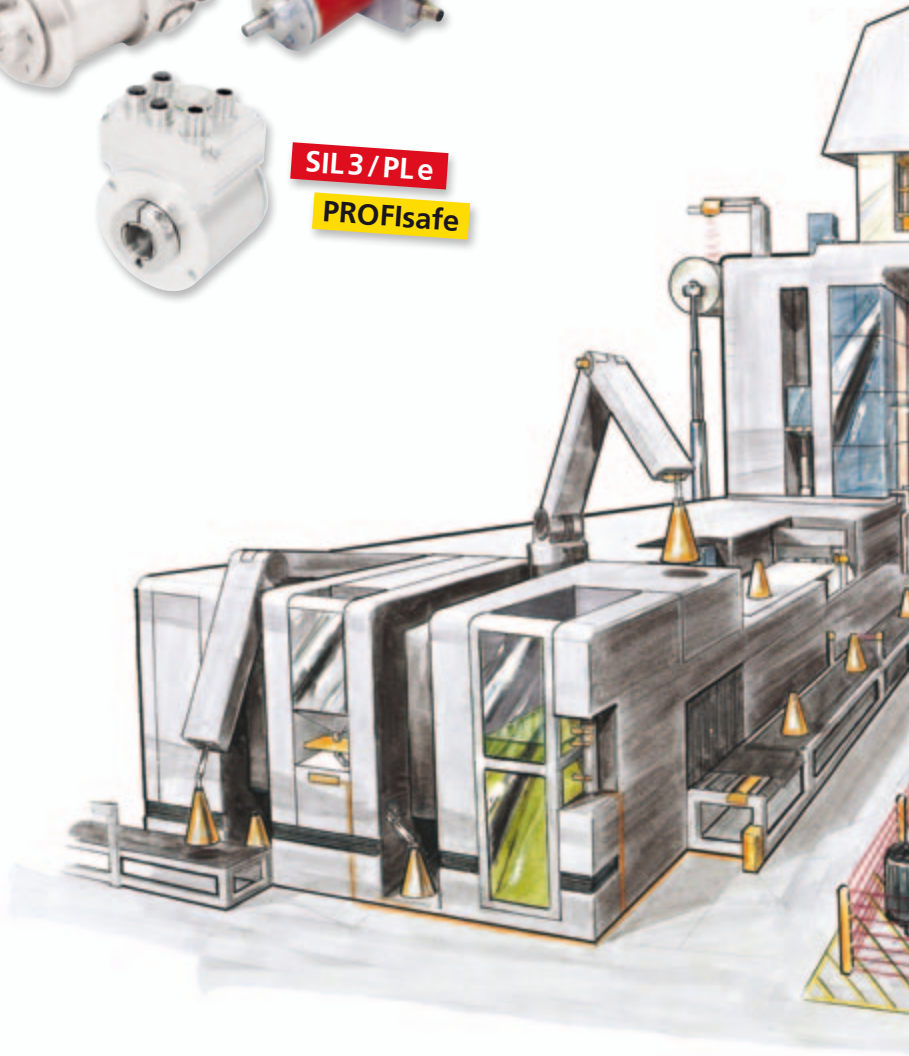

Intelligent positioning drive

Absolute positioning directly via fieldbus. Integrated motor, power electronics, closed loop controller, absolute encoder, PLC functions and fieldbus interface.

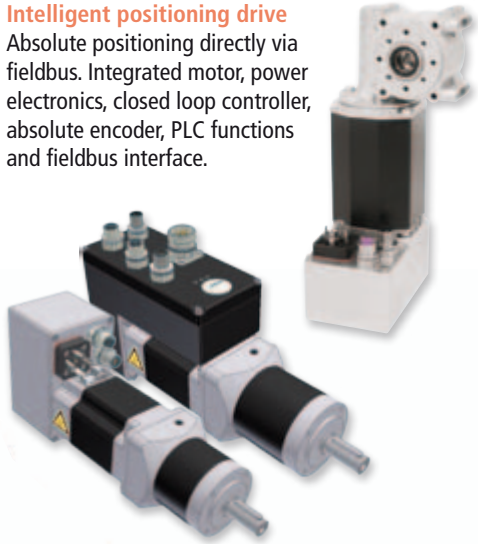

Heavy-duty industrial PC

Double shock proof mounted housing isolates the electronics from vibration, while front access (MIPC) simplifies configuration and start up. Choose from our wide selection of housings.

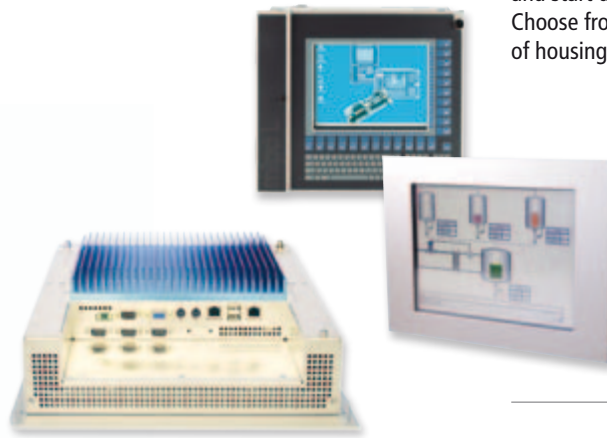

SPC – the PLC for PC

Turns every PC into an efficient PLC under S5/S7 or IEC 1131 protocols. Combines the comfort of PC control with the safety of a separate processor for PLC tasks.



@ctivelO – more than fieldbus modules

Modular, rugged fieldbus node system I/O-node, small-scale PLC, decentralized axis controller, high performance cam controller, DIN-rail mounted industrial PC, servo controller for the hydraulic ... with commercial fieldbus systems, such as Profibus-DP, CANopen, DeviceNet, LightBus ... and ETH-ERNET as option!



Laser distance measuring systems

Absolute and wear-free measurement of distances up to 200 m via SSI, fieldbus and Ethernet.

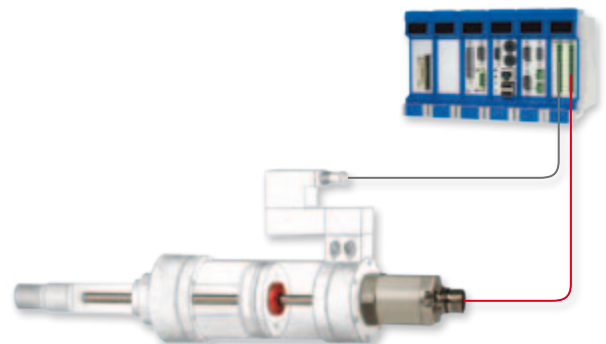

Headquarter

TR-Electronic GmbH
Eglshalde 6
D-78647 Trossingen
Germany

Tel.: +49/7425 228-0
Fax: +49/7425 228-33
info@tr-electronic.de
www.tr-electronic.de

International

Argentina

AEA Aparatos Eléctricos
Automáticos
S.A.C.I.E./Asunción 2130
AR-1419 Buenos Aires
Tel.: +54/11 - 4574 1155
Fax: +54/11 - 4574 2400
servicioalcliente@aea.com.ar
www.aea.com.ar

Australia

Sensor Measurement Pty Ltd.
Unit 8/26 Shields Crescent
P.O. Box 1079
AU-Booragoon
Western Australia 6154
Tel.: +61/8-93 17 25 52
Fax: +61/8-93 17 24 52
sales@
sensormeasurement.com.au
www.sensormeasurement.com.au

Austria

TR-Electronic GmbH
Tragösserstraße 117
A-8600 Bruck/Mur
Tel.: +43/38 62-5 50 06 0
Fax: +43/38 62-5 50 06 33
info@tr-electronic.at
www.tr-electronic.at

Belgium

Martek SPRL - BVBA
Rue du Broux 16
B-1320 Beauvechain
Tel.: +32/10 86 82 80
Fax: +32/10 86 82 89
info@martek.be
www.martek.be

Brazil

Grupo C+ Tecnologia
Rua dos Caetés
601 - Perdizes
BR - São Paulo - SP
CEP-05016-081
Tel.: +55/11-2168 6554
Fax: +55/11-2168 6555
info@ctecnologia.com.br
www.ctecnologia.com.br

Canada

TR Electronic
P.O. Box 2543, Station B
CDN-London, Ontario Canada
N6A 4G9
Tel.: +1/519-452 1999
Fax: +1/519-452 1177
customercare@trelectronic.com
www.trelectronic.com

China

TR-Electronic (Beijing) CO., LTD.
Rm. 1302, Side A, Lucky Tower
No. 3 Dongsanhuan North Road
Chaoyang District
CN-100027 Beijing, P.R. China
Tel.: +86/10 - 646 131 96
Fax: +86/10 - 646 135 51
lu.yu@tr-electronic.de
www.tr-electronic.cn

Czech Republic, Slovakia

DEL a.s.
Strojírenská 38
CZ-59101 Ždár nad Sázavou
Tel.: +420/566 657 100
Fax: +420/566 621 657
del@del.cz
www.del.cz

Denmark

TR-Electronic Danmark ApS
Hustedgårdvej 22
DK-8722 Hedensted
Tel.: +45/75 89 06 03
Fax: +45/75 89 06 36
cbj@tr-electronic.dk
www.tr-electronic.dk

Finland

Sarlin Oy Ab
P.O. Box 750
FI-00101 Helsinki
Tel.: +358/10 - 550 4000
Fax: +358/10 - 550 4201
info@sarlin.com
www.sarlin.com

France

TR-Electronic France SARL
1 Av. Christian Doppler
Bâtiment 2
F-77700 Serris
Tel.: +33/1-64 63 68 68
Fax: +33/1-61 10 17 66
info@tr-electronic.fr
www.tr-electronic.fr

Great Britain

TR-Electronic Limited
12a Oak Industrial Park
Great Dunmow
GB-Essex CM6 1XN
Tel.: +44/1 371-876 187
Fax: +44/1 371-876 287
info@tr-electronic.co.uk
www.tr-electronic.co.uk

India

Global-Tech (India) Pvt Ltd
404 White House
1482 Sadashiv Peth
IND-Tilak Road, Pune - 411 030
Tel.: +91/20- 2447 00 85
Fax: +91/20- 2447 00 86
info@globaltechindia.com
www.globaltechindia.com

Israel

DOR Drive Systems L.T.D.
P.O.Box 6
ISR-49910 Kibbutz Einat
Tel.: +972/3 9007595
Fax: +972/3 9007599
sales@dor1.co.il
www.dor1.co.il

Italy

Telestar S.r.l.
Via C. Colombo 13
I-22069 Rovellasca (Co)
Tel.: +39/02-96 74 02 68
Fax: +39/02-96 74 02 73
telestar@telestar-automation.it
www.telestar-automation.it

Japan

SANTEST CO. LTD.
1-60 Tsuneyoshi, 1-Chome
Konohanaku
J-Osaka 554-8691
Tel.: +81/6-6465 5561
Fax: +81/6-6465 5921
info@santest.co.jp
www.santest.co.jp

Mexico

TR Electronic
P.O. Box 2543, Station B
CDN-London, Ontario Canada
N6A 4G9
Tel.: +1/519-452 1999
Fax: +1/519-452 1177
customercare@trelectronic.com
www.trelectronic.com

Netherland

TR-Electronic Nederland BV
Postbus 1682
NL-6201 BR Maastricht
Tel.: +31/43 352 3614
Fax: +31/43 352 3555
info@tr-electronic.nl
www.tr-electronic.nl

Norway

TR Electronic Norway AS
Fusdal Terrasse 3
N-1387 Asker
Tel.: +46 708 696 533
Fax: +46 875 676 80
E-Mail: info@trelectronic.no
Homepage: www.trelectronic.no

Poland

Stoltronic-Polska Sp. z o.o.
ul. Dabrowskiego 238C
PL - 93-231 Lodz
Tel.: +48/42-649 12 15
Fax: +48/42-649 11 08
stoltronic@stoltronic.pl
www.stoltronic.pl

Singapore

Globaltec Electronics (Far East)
Pte. Ltd.
50 Bukit Batok Street 23
#06-27 Midview Building
SIN-659578 Singapore
Tel.: +65/6267 9188
Fax: +65/6267 8011
info@globaltec.com.sg
www.globaltec.com.sg

Slovenia

S.M.M. d.o.o.
Jaskova 18
SI-2001 Maribor
Tel.: +386/2450 2300
Fax: +386/2450 2302
smm@siol.net
www.smm.si

South Africa

Angstrom Engineering (Pty) Ltd.
19 Tom Muller Road
P.O. Box 793
SA-Meyerton 1960
Tel.: +27/16 3620300
Fax: +27/16 3620725
info@angstromeng.co.za
www.angstromeng.co.za

South Korea

MS Intech Co., Ltd.
B-306, Gasan Digital 1 Ro 119
Keumcheon-Gu
KOR-Seoul
Tel.: +82/2-334 0577
Fax: +82/2-862 1591
sales@msintech.com
www.msintech.com

Spain, Portugal

Intertronic Internacional, SL
C/Johannes Gutenberg, 4 y 6
P.I. Parque Tecnológico
E-46980 Valencia
Tel.: +34/96-375 8050
Fax: +34/96-375 1022
info@intertronic.es
www.intertronic.es

Sweden

TR Electronic Sweden AB
Enebybergsvägen 10B
S-182 36 Danderyd
Tel.: +46/8-756 72 20
Fax: +46/8-756 76 80
mailbox@trelectronic.se
www.trelectronic.se

Switzerland

TR-Electronic SA
14, Ch. Pré-Fleuri
CH-1228 Plan-les-Ouates/Genève
Tel.: +41/22-7 94 21 50
Fax: +41/22-7 94 21 71
info@tr-electronic.ch
www.tr-electronic.ch

Taiwan

Asia Jyujiang Enterprise Co., Ltd.
5F., No. 456, Minguan 2nd.
Qianzhen Dist.
Kaohsiung City 80654
Taiwan (R.O.C.)
Tel.: +886/7-3385067
Fax: +886/7-3380271
asiataiwan@seed.net.tw

Thailand

T+R Electronic (Thailand) Co.,
Ltd.
120/62 Moo 8 Bang Sare
TH - Sattahip, Chonburi 20250
Tel.: +66/38 737 487
Fax: +66/38 737 171
trthailand@trelectronic.co.th
www.trelectronic.co.th

Turkey

Üniversa İç-Dis Tic. ve
Mak. San. Ltd. Sti.
Cemal Gürsel Caddesi
No: 11 D: 4
TR-35600 Karsiyaka-IZMIR
Tel.: +90/232 382 23 14
Fax: +90/232 382 23 24
info@universa.com.tr
www.universa.com.tr

USA (TR-Electronic)

TR Electronic
P.O. Box 4448
US-Troy, MI 48099
Tel.: +1/248-244-2280
Fax: +1/248-244-2283
customercare@trelectronic.com
www.trelectronic.com

USA (TRsystems)

TRS Fieldbus Systems, Inc.
666 Baldwin Court
US-Birmingham, MI 48009
Tel.: +1/586 826-9696
Fax: +1/586 826-9697
support@trs-fieldbus.com
www.trs-fieldbus.com

Eastern Europe, CIS

Stoltronic Handels GmbH
Karl-Kurz Gasse 21
A-2482 Münchendorf
Tel.: +43/2259 30133
Fax: +43/2259 30149
stoltronic@aon.at



Copyright by TR-Electronic GmbH · All rights reserved · 68-105-097 · TR-V-PR-GB-0007 · January 2013

TR-Electronic GmbH
Eglishalde 6
D-78647 Trossingen

Tel. +49 (0)7425/228-0
Fax +49 (0)7425/228-33
info@tr-electronic.de

www.tr-electronic.de